

FAN PERFORMANCE DATA

HP075 BLOWERS

FAN DIMENSIONAL DATA

MOTOR SPEED: 2800 RPM  
AIR DENSITY: 1.2KG/M<sup>3</sup>

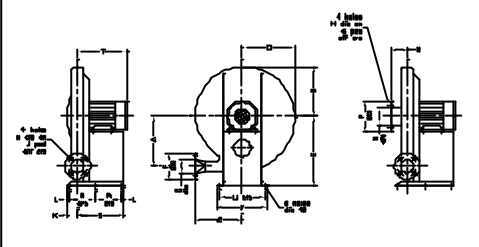
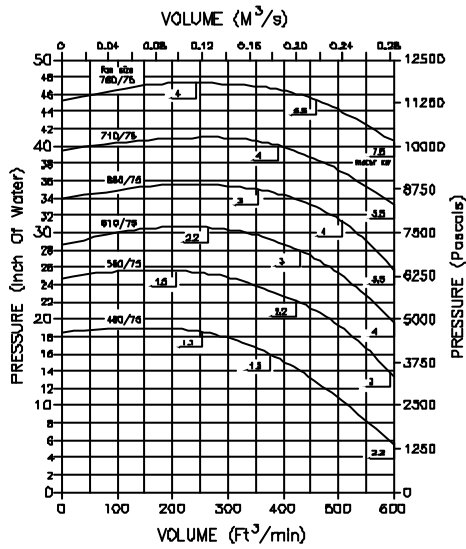

FAN SIZE	A	B	C	D	E	F	G	H	I	J	K	L	M	N	P	Q	MINI (mm)	R	S	T	U	V
480/75	308	308	288	324	438	168	75	11	127	72	17	84	118	203	180	1.0	180	213	246	284	328	378
540/75	344	344	324	360	474	180	75	11	127	72	17	84	118	204	186	1.2	183	216	250	288	332	382
610/75	368	368	348	384	498	192	75	11	127	72	17	84	118	204	186	1.4	183	216	250	288	332	382
680/75	392	392	372	408	522	204	75	11	127	72	17	84	118	204	186	1.6	183	216	250	288	332	382
710/75	416	416	396	432	546	216	75	11	127	72	17	84	118	204	186	1.8	183	216	250	288	332	382
780/75	440	440	420	456	570	228	75	11	127	72	17	84	118	204	186	2.0	183	216	250	288	332	382



FAN ENGINEERING (midlands) LTD  
18 Seng Myn, Anfield Road, Erding, Surrey, GU8 7JX  
Tel: 01827 57000, Fax: 01827 54441, e-mail: faneng@fem.com



Model: No. 480/75-780/75  
HP075 BLOWERS

Chart No: C1002B